



1147 6" CHAIN WRENCH

鍊管鉗

- Handle: 6"
- Chain: 18"



1148 12" CHAIN WRENCH

鍊管鉗

- Handle: 12"
- Chain: 20"

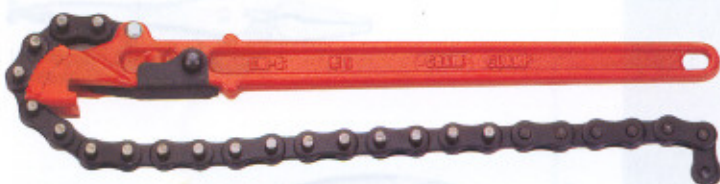

1149 20" CHAIN WRENCH

鍊管鉗

- Handle: 20"
- Chain: 25"



1150 12" STRAP WRENCH

帆布式鍊管鉗

- Handle: 12"
- Strap length: 36"



3704 SELF-ADJUST PLIERS

萬能鉗 7-1/2"

- The gripping span remains substantially constant for any size workpiece.
- Jaws always grip in parallel position up to 1-3/8" (35mm).
- Uniform, powerful grip.
- Self-adjusts to workpiece size.
- Super strong, laminated heat treated steel construction.



3705 SELF-ADJUST PLIERS

萬能鉗 9"

- The gripping span remains substantially constant for any size workpiece.
- Jaws always grip in parallel position up to 2" (50mm).
- Uniform, powerful grip.
- Self-adjusts to workpiece size.
- Super strong, laminated heat treated steel construction.

3304 CAR WHEEL THIN WALL DEEP IMPACT SOCKET SET

輪胎防傷套筒組

- Thin wall deep impact sockets are designed to allow easy access to recessed wheel nuts where space is limited.
- With additional outside plastic sleeve to protect the rims when screwing the wheel screws.
- Material: CR-MO; Total length: 87mm.
- Size:
 - 17mm - with blue plastic sleeve
 - 19mm - with yellow plastic sleeve
 - 21mm - with red plastic sleeve



3119 4PC STUD PULLER WRENCH

無頭螺絲套筒組

- Made of chrome vanadium.
- Special designed for winding out screw damaged or screw without head.
- Size: 6, 8, 10, 12mm.



1208 DAMAGED NUTS REMOVER KIT

專利型反牙套筒組

- Size: 12, 14, 17, 19, 21
- Used when the damaged screws head or nuts was not easy to remove.
- Special tapered and reversal thread design for strongly locked the screw.
- There has six ditches, used to align the screws.
- Patented



1321 TWIST SOCKET SET (12PCS)

螺旋式防脫套筒

- Use on the damaged screws & nuts.
- Special spiral design for easier to remove the damaged screws.
- Size:
 - 3/8" Dr. 8, 10, 12, 13mm (Length: 32 mm)
 - 1/2" Dr. 14, 15, 16, 17, 19, 21mm (Length: 34 mm)
 - 2 pcs pin punches 72, 80 mm



1322 DEEP TWIST SOCKET SET (5PCS)

中長螺旋式防脫套筒

- Use on the damaged screws & nuts.
- Special spiral design for easier to remove the damaged screws.
- The deep design for easier use on the tire screws.
- Size: 1/2" Dr. 17, 19, 21, 22mm; Length: 50mm



T型長套筒扳手 T HANDLE SOCKET WRENCH

· Drop forged chrome vanadium steel, heat treated & chrome plated.

編號 Item	規格 Spec	編號 Item	規格 Spec
3655	8mm x 300 L	3659	12mm x 300 L
3656	9mm x 300 L	3660	13mm x 300 L
3657	10mm x 300 L	3661	14mm x 300 L
3658	11mm x 300 L	3662	17mm x 300 L

T型萬向套筒扳手 UNIVERSAL T HANDLE SOCKET WRENCH

· Drop forged chrome vanadium steel, heat treated & chrome plated.
· Extra long universal socket T handle for jobs in hard to reach places.
· Universal head gives steady flexibility.

編號 Item	規格 Spec	編號 Item	規格 Spec
3631	8mm x 320 L	3634	12mm x 320 L
3632	10mm x 320 L	3635	13mm x 320 L
3633	11mm x 320 L	3636	14mm x 320 L
3637	8mm x 450 L	3640	12mm x 450 L
3638	10mm x 450 L	3641	13mm x 450 L
3663	11mm x 450 L	3664	14mm x 450 L
3665	8mm x 600 L	3646	12mm x 600 L
3644	10mm x 600 L	3647	13mm x 600 L
3645	11mm x 600 L	3648	14mm x 600 L

T型萬向火星塞扳手(附磁) UNIVERSAL T HANDLE SPARK PLUG WRENCH

· 450mm handle for hard to reach recessed spark plugs.
· Avoids burns form engine heat.
· Universal head gives steady flexibility.
· The socket with magnetic.

編號 Item	規格 Spec
3649	5/8" (16mm) x 450L
3650	13/16" (21mm) x 450L

3443 T HANDLE UNIVERSAL BIT SPINNER

T型萬向起子頭板手

· Length: 460mm x 180mm
· 1/4" quick release bit spinner for any kind bits.
· Special universal design for operating in narrow space.

3442 T HANDLE DOUBLE UNIVERSAL RATCHET

T型雙萬向棘輪板手

· Length: 460mm x 180mm
· 1/4" DR. Ratchet with 72 teeth and 300° swivel.
· Special double universal design for operating in any space.

T型萬向接桿 UNIVERSAL T HANDLE EXTENSION BAR

- Square drive universal joint, extra long for jobs in hard to reach places.

編號 Item	規格 Spec
3651	1/2" Dr. x 320L
3652	1/2" Dr. x 600L
3666	3/8" Dr. x 320L
3667	3/8" Dr. x 600L

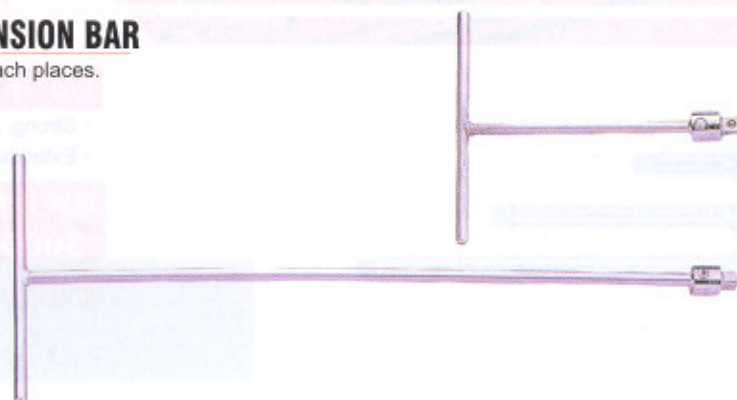

萬向接桿 UNIVERSAL EXTENSION BAR

- Square drive universal joint, extra long for jobs in hard to reach places.

編號 Item	規格 Spec
3653	1/2" Dr. x 320L
3654	1/2" Dr. x 600L
3213	3/8" Dr. X 320L
3920	3/8" Dr. x 600L

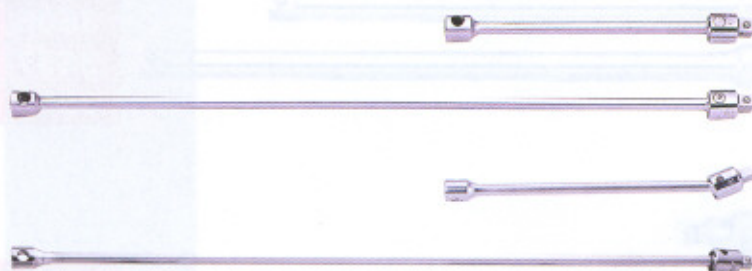

特長型接桿 EXTRA LONG EXTENSION BAR

- Strong, chrome plated steel drive extensions.
- Extends ratchet from fastener for more freedom of ratchet movement.
- Chrome-vanadium steel.

編號 Item	規格 Spec
3906	1/4" Dr. x 14"
3907	3/8" Dr. x 18"
3908	1/2" Dr. x 24"

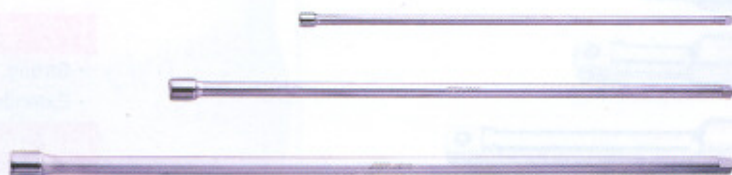

3001 1/4" FLEXIBLE EXTENSION BAR

1/4"x18"軟性接桿

- Extra long 1/4" Dr. flexible extension bar.
- Allows easy access in tight spaces.
- Full length: 18"





1/4" 手動延長接桿 1/4" Dr. EXTENSION BAR

- Strong, chrome plated steel drive extensions.
- Extends ratchet from fastener for more freedom of ratchet movement.

編號 Item	規格 Spec	編號 Item	規格 Spec
3006	1/4" x 2"	3008	1/4" x 6"
3007	1/4" x 4"		

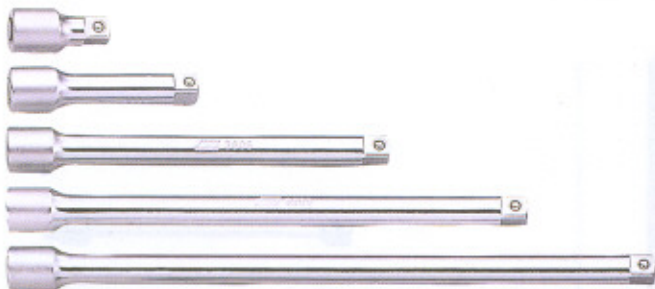

3/8" 手動延長接桿 3/8" Dr. EXTENSION BAR

- Strong, chrome plated steel drive extensions.
- Extends ratchet from fastener for more freedom of ratchet movement.

編號 Item	規格 Spec	編號 Item	規格 Spec
3606	3/8" x 1-3/4"	3609	3/8" x 8"
3607	3/8" x 3"	3610	3/8" x 10"
3608	3/8" x 6"		



3/8" 15° 萬向延長接桿 3/8" Dr. WOBBLE EXTENSION BAR

- Wobble extension allow sockets to flex 15° in any direction.
- This enables the operator to reach fasteners that may be situated in areas that are not accessible with standard extensions.

編號 Item	規格 Spec	編號 Item	規格 Spec
3619	3/8" x 1-3/4"	3621	3/8" x 6"
3620	3/8" x 3"	3622	3/8" x 10"

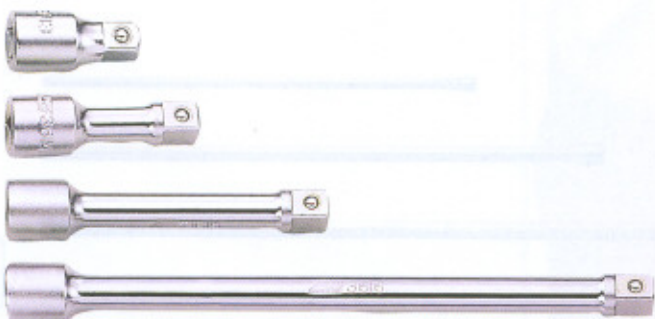

1/2" 手動延長接桿 1/2" Dr. EXTENSION BAR

- Strong, chrome plated steel drive extensions.
- Extends ratchet from fastener for more freedom of ratchet movement.

編號 Item	規格 Spec	編號 Item	規格 Spec
3613	1/2" x 2"	3615	1/2" x 5"
3614	1/2" x 3"	3616	1/2" x 10"

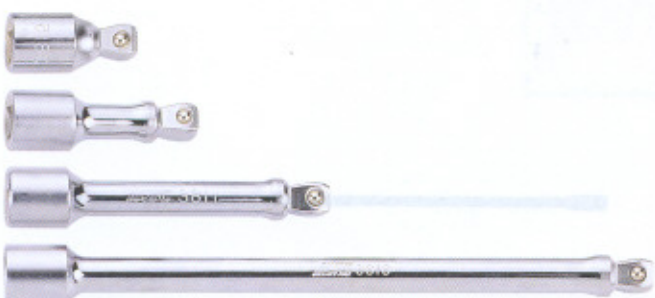

1/2" 15° 萬向延長接桿 1/2" Dr. WOBBLE EXTENSION BAR

- Wobble extension allow sockets to flex 15° in any direction.
- This enables the operator to reach fasteners that may be situated in areas that are not accessible with standard extensions.

編號 Item	規格 Spec	編號 Item	規格 Spec
3815	1/2" x 2"	3817	1/2" x 5"
3816	1/2" x 3"	3818	1/2" x 10"

氣動萬向接頭 IMPACT UNIVERSAL JOINTS

- Perfect for using with air impact wrench and other impact tools in an offset position.
- The universal joint allows for a smooth, bind free action while increasing access.

編號 Item	規格 Spec	長度 Length
3706	3/8" Dr.	50mm
3703	1/2" Dr.	60mm



手動萬向接頭 UNIVERSAL JOINT

- Spring-stiffened joint. Stays in position when reaching for fasteners. Substantial time-savings.

編號 Item	規格 Spec
3719	1/4"
3720	3/8"
3721	1/2"



3204 FLOPPY UNIVERSAL JOINTS

1/2" 軟萬向接頭(附彈簧)

- Special two ball design, increased the revolve angles.
- Spring is to prevent the joint stuck when the angle is too big.
- Made of chrome-moly.
- 1/2" DR



掌心型棘輪扳手 PALM RATCHET

- Smallest design for operating in narrow space.
- 72 teeth & reversible.

編號 Item	規格 Spec	外徑 Dia.	長度 Length
3440	1/4"	48Φ	27mm
3441	3/8"	48Φ	24mm

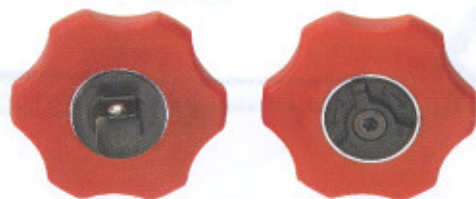

滑動扳桿 SLIDING T BAR

- Square drive locks along the bar to form a T or L-shaped handle.

編號 Item	規格 Spec
3716	1/4" x 5"
3717	3/8" x 10"
3718	1/2" x 12"
3729	3/4" x 20"

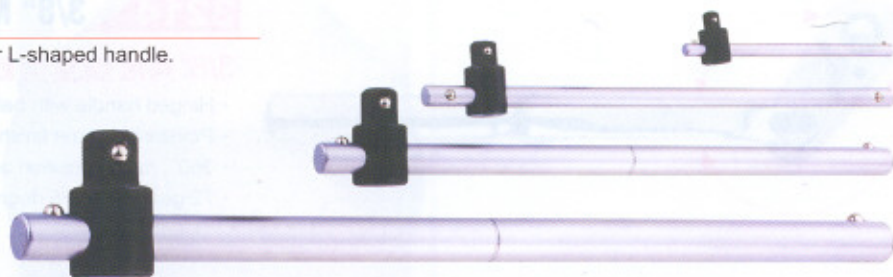

強力扳桿 PROFESSIONAL BREAKER BAR

- Drop forged alloy steel square drive swivels 180 degrees.
- Strong chrome vanadium steel handle for any tough job give you extra torque to break loose stubborn nuts.

編號 Item	規格 Spec
3714	1/4" x 6"
3715	3/8" x 10"
3617	1/2" x 15"
3618	1/2" x 18"
3624	1/2" x 24"
3730	3/4" x 24"

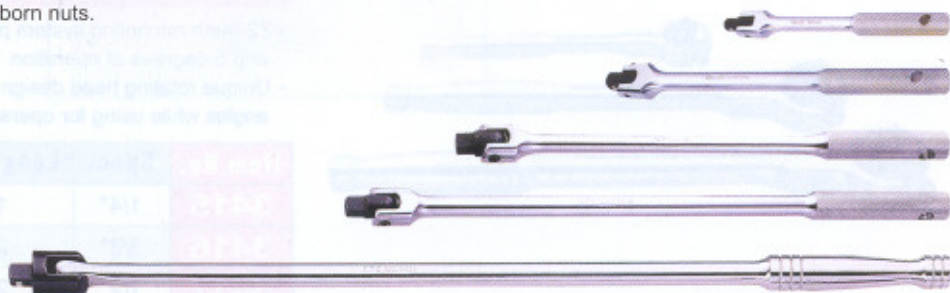

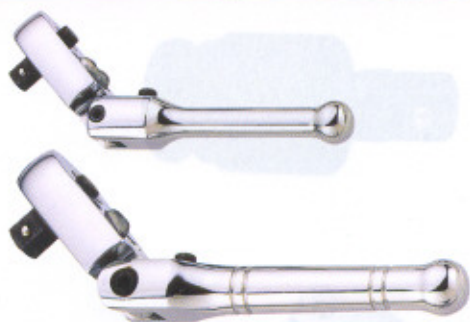

短型搖頭固定式棘輪扳手 LOCKING FLEXIBLE RATCHETS

- Locking type hinged with ball joint for optimum clearance.
- Polished chrome finish.

編號 Item	規格 Spec	長度 Length
3012	1/4"	124mm
3015	3/8"	162mm

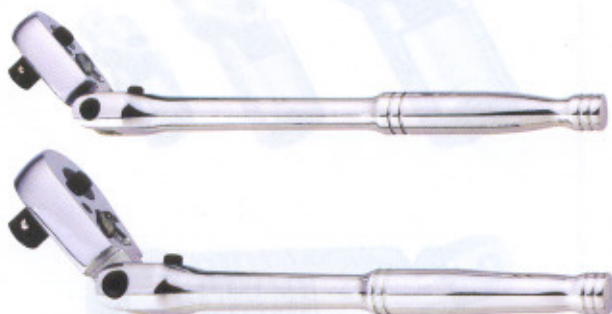

搖頭固定式棘輪扳手 LOCKING FLEXIBLE RATCHETS

- Locking type hinged with ball joint for optimum clearance.
- Polished chrome finish.

編號 Item	規格 Spec	長度 Length
3013	3/8"	265mm
3014	1/2"	280mm



3812 3/8" FLEXIBLE RATCHETS

3/8" 搖頭棘輪扳手

- Hinged handle with ball joint for optimum clearance
- Polished chrome finish.

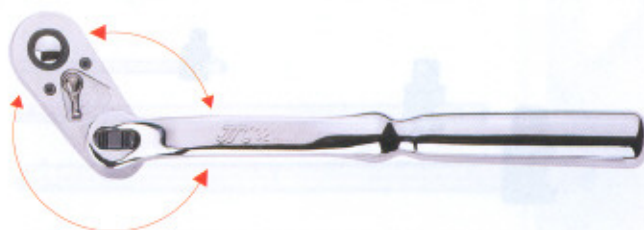

3214 3/8" MULTI - POSITION HEAD RATCHET

3/8" 角度調整型棘輪扳手

- Hinged handle with ball joint for optimum clearance
- Polished chrome finish.
- 360° multi - position adjustable.
- 72 gear teeth & 5 degree gear action.



旋轉頭型棘輪扳手 ROTATING RATCHET

- 72-teeth ratcheting system provides high torque and 5 degrees of operation in small areas.
- Unique rotating head design can adjust any angles while using for operation quickly.

Item No.	Spec.	Length(mm)
3415	1/4"	146
3416	3/8"	227
3417	1/2"	286



短型棘輪扳手 STUBBY RATCHETS

- Short type ratchet.
- Easy to operate in hard to reach places.

編號 Item	規格 Spec	長度 Length
3016	1/4"	89mm
3017	3/8"	110mm
3018	1/2"	130mm

棘輪扳手 RATCHETS

- Thin head design for access into tight work areas.
- Reversing lever designed for quick one hand operation.

編號 Item	規格 Spec	長度 Length
3602	1/4"	128mm
3603	3/8"	182mm
3604	1/2"	248mm
3630	3/4"	503mm



超小頭棘輪扳手 MINI HEAD RATCHET

- Super mini head design for using in limited space.
- 72 teeth design.
- Light and portable.

編號 Item	規格 Spec	外徑 Dia.	重量 Weight	長度 Length
3444	1/4"	20mm	83g	130mm
3445	3/8"	25.5mm	213g	200mm
3446	1/2"	32.5mm	400g	250mm



音響式扭力扳手 CLICK-TYPE TORQUE WRENCH

編號 Item	Dr.	Range of the Torque
1201	1/4"	20~200INCH / 2.3~22.6NM
1202	3/8"	10~80FT/LB / 13.6~108.5NM
1203	1/2"	10~150FT/LB / 13.6~203.5NM
1204	1/2"	25~250FT/LB / 33.9~339NM
1205	3/4"	50~300FT/LB / 67.8~406.7NM
1206	3/4"	100~500FT/LB / 135.6~667.9NM



音響式扭力扳手(視窗型) CLICK-TYPE TORQUE WRENCH

- D type ratchet 48T. The smallest adjusted angle is 7.5° .
- Window type. It can accurately adjust the value in advance.
- The quality of handle is soft rubber material, and easy to grasp.
- With pulls/presses way to set the value in the end of handle.
- It is stable for pre-set value, cannot move when you use.
- Accurately torque setting, erroneous value 3%.

編號 Item	Dr.	Range of the Torque
1369	3/8"	19~110nm
1370	1/2"	42~210nm



棘輪梅開扳手(5°) GEAR COMBINATION WRENCHES

- Chrome - vanadium steel and mirror polished.
- Unique 72 - teeth ratcheting system provides high torque and 5 degree of operation in tight areas.

編號 Item	規格 Spec	編號 Item	規格 Spec
3029	8 mm	3035	15 mm
3030	10 mm	3036	16 mm
3031	11 mm	3037	17 mm
3032	12 mm	3038	18 mm
3033	13 mm	3039	19 mm
3034	14 mm		

棘輪梅開扳手組 GEAR COMBINATION WRENCH SETS

編號 Item	規格 Spec	
3027	4pcs	8, 10, 12, 14.
3028	10pcs 3pcs	8, 10, 11, 12, 13, 14, 15, 16, 17, 19. Adapter: 1/4", 3/8", 1/2".

搖頭棘輪梅開扳手 FLEXIBLE COMBINATION GEAR WRENCH

- 72 teeth gear design, 5 degree adjust angle.
- Flexible design for best operating angle.

編號 Item	規格 Spec	編號 Item	規格 Spec
3449	8mm	3455	15mm
3450	10mm	3456	16mm
3451	11mm	3457	17mm
3452	12mm	3458	18mm
3453	13mm	3459	19mm
3454	14mm		

搖頭棘輪梅開扳手組 FLEXIBLE COMBINATION GEAR WRENCH SET

編號 Item	規格 Spec	
3447	4PCS	8,10,12,14
3448	9PCS	8,10,11,12,13,14,15,16,17



鏡面短型梅開板手 STUBBY COMBINATION WRENCH

• Made from Chrome Vanadium material and mirror finished.

編號 Item	規格Spec	長度Length	編號 Item	規格Spec	長度Length
AD06	6	77	AD13	13	109
AD07	7	80	AD14	14	114
AD08	8	85	AD15	15	120
AD09	9	90	AD16	16	124
AD10	10	95	AD19	17	130
AD11	11	100	AD17	18	134
AD12	12	104	AD18	19	140



AD09S 9PCS STUBBY COMBINATION WRENCH SET

9PCS 鏡面短型梅開板手

• Contents: 8, 10, 11, 12, 13, 14, 15, 16, 17



鏡面特長梅開板手 EXTRA LONG COMBINATION WRENCH

• Made from Chrome Molybdenum material and mirror finished.

編號 Item	規格Spec	長度Length	編號 Item	規格Spec	長度Length
LS10	10	190	LS15	15	275
LS11	11	205	LS16	16	295
LS12	12	220	LS17	17	310
LS13	13	240	LS18	18	330
LS14	14	260	LS19	19	343



LS10S EXTRA LONG COMBINATION WRENCH SET

10PCS 鏡面特長梅開板手組

• Contents: 10, 11, 12, 13, 14, 15, 16, 17, 18, 19





鏡面E星型板手 STAR TYPE OFF SET WRENCH

• Made from Chremo-Vanadium, and mirror finished.

編號 Item	規格Spec	長度Length	編號 Item	規格Spec	全長Length
EF0608	E6 x E8	114	EF1418	E14 x E18	180
EF0711	E7 x E11	130	EF1622	E16 x E22	205
EF1012	E10 x E12	141	EF2024	E20 x E24	224



鏡面E星型板手組 STAR TYPE OFF SET WRENCH SET

• Made from Chremo-Vanadium, and mirror finished.

編號 Item	規格Spec				
EF4S	4pcs	E6xE8, E10xE12, E14xE18, E16xE22			
EF6S	6pcs	E6xE8, E7xE11, E10xE12, E14xE18, E16xE22, E20xE24			



鏡面薄型梅開板手 COMBINATION WRENCH

• Chrome - vanadium steel and mirror polished.

編號 Item	規格Spec	長度Length	編號 Item	規格Spec	長度Length
AE1206	6	102	AE1219	19	230
AE1207	7	112	AE1220	20	240
AE1208	8	122	AE1221	21	250
AE1209	9	131	AE1222	22	260
AE1210	10	140	AE1223	23	270
AE1211	11	150	AE1224	24	280
AE1212	12	160	AE1225	25	290
AE1213	13	170	AE1226	26	300
AE1214	14	180	AE1227	27	310
AE1215	15	190	AE1228	28	320
AE1216	16	200	AE1229	29	330
AE1217	17	210	AE1230	30	340
AE1218	18	220	AE1232	32	360



AE1206S COMBINATION WRENCH SETS

鏡面薄型梅花板手組15PCS

• Contents: 6, 7, 8, 9, 10, 11, 12, 13, 14, 15, 16, 17, 18, 19, 21

霧面薄型梅開板手 COMBINATION WRENCH

- European type
- Chrome-vanadium steel and special heat treatment permit thin walls for strength.
- DIN-3113 standard; GS approved.
- Contents: 6-50mm Metric Set

編號 Item	規格 Spec	長度 Length(m/m)	編號 Item	規格 Spec	長度 Length(m/m)
AE2406	6	105	AE2423	23	275
AE2407	7	115	AE2424	24	285
AE2408	8	125	AE2425	25	295
AE2409	9	135	AE2426	26	305
AE2410	10	145	AE2427	27	315
AE2411	11	155	AE2428	28	325
AE2412	12	165	AE2429	29	335
AE2413	13	175	AE2430	30	345
AE2414	14	185	AE2432	32	365
AE2415	15	195	AE2433	33	380
AE2416	16	205	AE2434	34	380
AE2417	17	215	AE2435	35	410
AE2418	18	225	AE2436	36	410
AE2419	19	235	AE2438	38	438
AE2420	20	245	AE2441	41	460
AE2421	21	255	AE2446	46	500
AE2422	22	265	AE2450	50	540



霧面薄型梅開板手組 COMBINATION WRENCH SETS

- European type
- Chrome-vanadium steel and special heat treatment permit thin walls for strength.
- DIN-3113 standard; GS approved.

編號 Item	規格 Spec
AE2415S	15PCS 6,7,8,9,10,11,12,13,14,15,16,17,18,19,21
AE2417S	17PCS 8,9,10,11,12,13,14,15,16,17,18,19,21,22,23,24,27
AE2426S	26PCS 6,7,8,9,10,11,12,13,14,15,16,17,18,19,20,21,22,23,24,25,26,27,28,29,30,32



AE2417S



AE2415S



AE2426S





開口型單梅花棘輪板手 OPENING SINGAL ENDED RATCHET WRENCH

- Made by CR-MO material, chrome plated with burnished finish head.
- Special design for fast operations on hydraulic, diesel injection and compressed air installation nipples.
- With ratchet function, no need to take the wrench off the nipple to re-engage.

編號 Item	規格 Spec	長度 Length	編號 Item	規格 Spec	長度 Length
332510	10mm	150mm	332514	14mm	150mm
332511	11mm	150mm	332517	17mm	200mm
332512	12mm	150mm	332519	19mm	200mm
332513	13mm	150mm	332522	22mm	225mm

3325S OPENING SINGAL ENDED RATCHET WRENCH SET

開口型單梅花棘輪板手組

- Made by CR-MO material, chrome plated with burnished finish head.
- Contents: 10, 12, 14, 17, 19, 22mm



鏡面弓型梅花扳手 HALF MOON OFFSET BOX WRENCH

- Curve design is consider the space and angle.
- Material: chromium vanadium.

編號 Item	規格 Spec	長度 Length	編號 Item	規格 Spec	長度 Length
EV1012	10x12	142	EV1618	16x18	219
EV1113	11x13	164	EV1719	17x19	219
EV1214	12x14	164	EV1922	19x22	255
EV1417	14x17	190			

EV1012S HALF MOON OFFSET BOX WRENCH SET

鏡面弓型梅花扳手組5PCS

- Contents: 10x12, 11x13, 12x14, 14x17, 16x18

鏡面雙套筒搖頭扳手 DOUBLE SOCKET FLEXIBLE WRENCH

- Mirror polished, chrome vanadium steel.
- An all-purpose tool does the work of socket wrench, box end wrench and nut drivers.

編號 Item	規格 Spec	編號 Item	規格 Spec
3909	10 x 11mm	3911	14 x 15mm
3910	12 x 13mm	3912	16 x 17mm

3909S 4PC DOUBLE SOCKET FLEXIBLE WRENCH SET

鏡面雙套筒搖頭扳手組

- Mirror polished, chrome vanadium steel.
- An all-purpose tool does the work of socket wrench, box end wrench and nut drivers.
- Contents: 10 x 11mm, 12 x 13mm, 14 x 15mm, 16 x 17mm.



特長平型梅花扳手 EXTRA LONG OFFSET BOX WRENCH

- Special extra long design. Material is the chrome molybdenum.
- Easy to use in the confined space, such as pulley core screws and the water tank frame screws, etc.

編號 Item	規格 Spec	長度 Length	編號 Item	規格 Spec	長度 Length
3226	8x10	235	3212	14x17	390
3219	10x12	291	3221	16x18	407
3220	12x14	328	3222	17x19	407
3211	13x15	390	3227	22x24	431

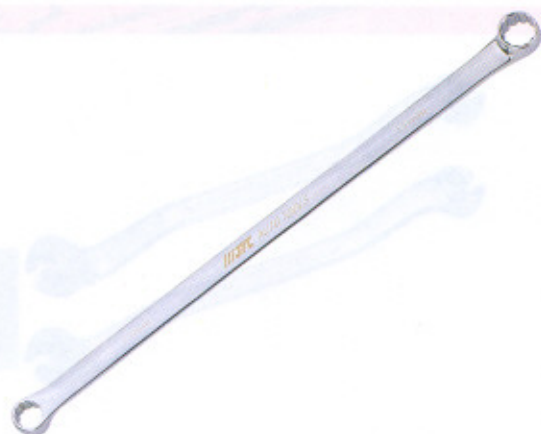

3219S EXTRA LONG OFFSET BOX WRENCH SET

加長平型梅花扳手組6PCS

- Contents: 10x12, 12x14, 13x15, 14x17, 16x18, 17x19



鏡面梅花扳手 OFFSET BOX WRENCH

- Chrome - vanadium steel and mirror polished.

編號 Item	規格 Spec	長度 Length	編號 Item	規格 Spec	長度 Length
PR0607	6x7	162	PR1617	16x17	256
PR0809	8x9	179	PR1719	17x19	296
PR0810	8x10	179	PR1819	18x19	296
PR1012	10x12	196	PR1921	19x21	311
PR1113	11x13	215	PR2123	21x23	351
PR1214	12x14	215	PR2224	22x24	351
PR1415	14x15	247	PR2326	23x26	351
PR1417	14x17	256	PR2427	24x27	372



PR1012S OFFSET BOX WRENCH SET

鏡面梅花扳手組6PCS

- Contents: 10x12, 12x14, 14x17, 17x19, 19x21, 22x24





加蓋型油管扳手 FLARE NUT WRENCH

- Special tool for replacing brake pipe.
- Chrome-molybdenum steel.
- Special design with cover for holding the nut completely and prevent slipping.

編號 Item	規格 Spec
1939	10 x 11 mm
1940	10 x 12 mm



鏡面油管扳手 FLARE NUT WRENCH

- Flat panel; flare nut drive; all drop forged from chrome vanadium steel conforms to American National standard Institution (ANSI)

編號 Item	規格 Spec	編號 Item	規格 Spec	編號 Item	規格 Spec
1821	8 x 9 mm	1824	11 x 13 mm	1019	17 x 19 mm
1017	8 x 10 mm	1825	12 x 14 mm	1120	3/8" x 7/16"
1822	10 x 11 mm	1826	14 x 17 mm	1121	1/2" x 9/16"
1823	10 x 12 mm	1018	16 x 18 mm		



鏡面油管扳手組 FLARE NUT WRENCH SET

- Flat panel; flare nut drive; all drop forged from chrome vanadium steel conforms to American National Standard Institution (ANSI)

編號 Item	規格 Spec	
18214	4PCS	8 x 9, 10 x 12, 11 x 13, 14 x 17
18216	6PCS	8 x 9, 10 x 11, 10 x 12, 11 x 13, 12 x 14, 14 x 17
18218	8PCS	8 x 9, 10 x 11, 10 x 12, 11 x 13, 12 x 14, 14 x 17, 16 x 18, 17 x 19

1605 3/8" DELUXE CROWS-FOOT WRENCH SET

3/8"單開口扳手組

- Contents: 10, 11, 12, 13, 14, 15, 16, 17, 18, 19mm.
- Made from Chrome-Molybdenum steel with a gap for use on union nuts fitted in hydraulic, oil, diesel injection and compressed air systems.

1/2"單開口扳手 1/2" DELUXE METRIC CROWS-FOOT WRENCH

- Made from Chrome-Molybdenum steel with a gap for use on union nuts fitted in hydraulic, oil, diesel injection and compressed air systems.

編號 Item	規格 Spec	編號 Item	規格 Spec	編號 Item	規格 Spec
1924	20 mm	1928	24 mm	1932	28 mm
1925	21 mm	1929	25 mm	1933	30 mm
1926	22 mm	1930	26 mm	1934	32 mm
1927	23 mm	1931	27 mm		



火星塞套筒(附磁六角) **MAGNETIC SPARK PLUG SOCKETS**

- Heat treated chrome vanadium steel socket with built in strong magnetic insert, never drops spark plugs when working.
- A perfect tool for spark plug service.

編號 Item	規格 Spec
1815	3/8" Dr.X 5/8" (16mm)
1816	3/8" Dr.X 13/16" (21mm)
1817	1/2" Dr.X 5/8" (16mm)
1818	1/2" Dr.X 13/16" (21mm)



火星塞套筒(膠套型) **SPARK PLUG SOCKETS**

- Heat treated chrome vanadium steel With rubber insert to hold the plugs when working.

編號 Item	規格 Spec
36516	3/8" Dr.X 5/8" (16mm)
36521	3/8" Dr.X 13/16" (21mm)
46516	1/2" Dr.X 5/8" (16mm)
46521	1/2" Dr.X 13/16" (21mm)



3905 **MAGNETIC SPARK PLUG KITS**

火星塞套筒組(附磁)

- 1PC 3/8" dr. swivel head ratchet.
- 1PC 1-3/4" extension bar.
- 1PC 3" extension bar.
- 1PC 16mm spark plug with magnet.
- 1PC 21mm spark plug with magnet.

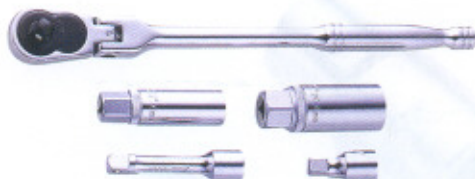

3605 **3/8" UNIVERSAL SOCKET SET**

3/8"萬向套筒組 ○

- Vehicles and industrial equipment are using smaller components requiring smaller fasteners. 3/8" drive flex sockets help mechanics get into tight places to remove these small fasteners.
- Contents: 10, 11, 12, 13, 14, 15, 16, 17, 18, 19mm.



3439 **14PCS GO-THROUGH SOCKET SET**

14PCS 通孔型套筒組 ○

- Contents:
- 10 pc Socket: 10,11,12,13,14,15,16,17,18,19mm
- 2 pc adapter: 3/8", 1/4" DR..
- 1 pc extension bar
- 1 pc 72 teeth go-through reverse combination ratchet.

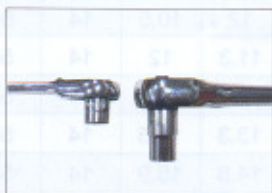



1/4" 手動套筒 1/4" DR. 6PT. SOCKET

- 6PT., metric size
- Material: Chrome vanadium

編號 Item	S	A	B	C	L
22504	4	11.8	6.8	12.5	25
22545	4.5	11.8	7.4	12.5	25
22505	5	11.8	8	12.5	25
22555	5.5	11.8	8.6	12.5	25
22506	6	11.8	9.2	12.5	25
22507	7	11.8	10.5	12.5	25
22508	8	11.3	11.8	11.5	25
22509	9	12.3	12.9	11.5	25
22510	10	13.3	14.4	11.5	25
22511	11	14.8	15.9	11.5	25
22512	12	15.8	16.9	11.5	25
22513	13	16.8	17.9	11.5	25
22514	14	17.8	19.9	11.5	25

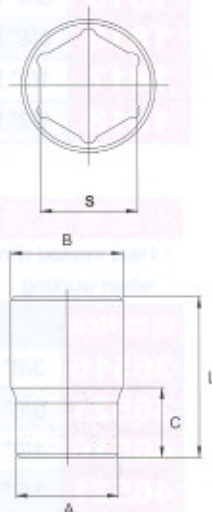

1/4" 手動套筒 1/4" DR. 6PT. SOCKET

- 6PT., SAE size
- Material: Chrome vanadium

編號 Item	S	A	B	C	L
224532	5/32	11.8	6.8	12.5	25
224316	3/16	11.8	7.7	12.5	25
224732	7/32	11.8	8.6	12.5	25
22414	1/4	11.8	9.5	12.5	25
224932	9/32	11.8	10.7	12.5	25
224516	5/16	11.3	11.8	11.5	25
2241132	11/32	12.3	12.9	11.5	25
22438	3/8	13.3	14.4	11.5	25
2241332	13/32	13.3	14.4	11.5	25
224716	7/16	14.8	15.9	11.5	25
2241532	15/32	15.8	16.9	11.5	25
22412	1/2	16.8	16.9	11.5	25

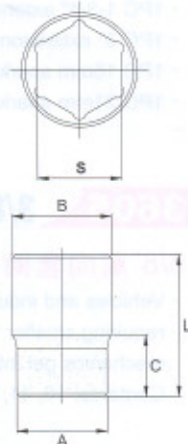

1/4" 長型手動套筒 1/4" DR. 6PT. DEEP SOCKET

- 6PT., Metric size
- Material: Chrome vanadium

編號 Item	S	A	B	C	L
25204	4	12	6.8	14	50
25205	5	12	8	14	50
25255	5.5	12	8.6	14	50
25206	6	12	9.2	14	50
25207	7	12	10.5	14	50
25208	8	11.3	12	14	50
25209	9	12.3	13	14	50
25210	10	13.3	14.5	14	50
25211	11	14.8	15.9	14	50
25212	12	15.8	16.9	14	50
25213	13	16.8	17.9	14	50
25214	14	17.8	19.9	14	50

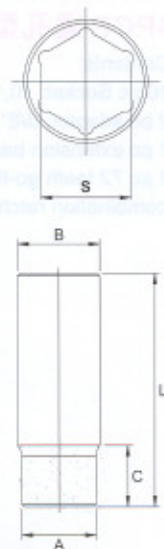

3/8" 手動套筒 3/8" DR. 6PT. SOCKET

- 6PT., metric size
- Material: Chrome vanadium

編號 Item	S	A	B	C	L
33206	6	16.8	9.6	15	28
33207	7	16.8	10.7	15	28
33208	8	16.8	11.9	15	28
33209	9	16.8	13.3	15	28
33210	10	16.8	14.3	15	28
33211	11	16.8	15.7	15	28
33212	12	16.3	17	12.5	28
33213	13	17	18	12.5	28
33214	14	18.8	19.5	12.5	28
33215	15	19.8	20.9	12.5	28
33216	16	20.8	21.9	12.5	28
33217	17	22	23.4	12.5	30
33218	18	22.8	24.4	12.5	30
33219	19	23.8	25.9	12.5	30
33221	21	25.8	27.9	12.5	32
33222	22	27.8	29.9	12.5	32

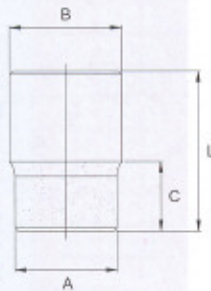
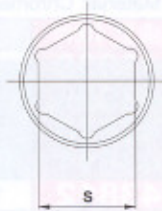

3/8" 長型手動套筒 3/8" DR. 6PT. DEEP SOCKET

- 6PT., metric size
- Material: Chrome vanadium

編號 Item	S	A	B	C	L
36306	6	17	9.6	17	63
36307	7	17	10.7	17	63
36308	8	17	11.9	17	63
36309	9	17	13.3	17	63
36310	10	17	14.3	17	63
36311	11	17	15.7	17	63
36312	12	16.3	17	17	63
36313	13	17	18	17	63
36314	14	18.8	19.5	17	63
36315	15	19.8	20.9	17	63
36316	16	20.8	21.9	17	63
36317	17	22	23.4	17	63
36318	18	22.8	24.4	17	63
36319	19	23.8	25.9	17	63
36321	21	25.8	27.9	17	63
36322	22	27.8	29.9	17	63

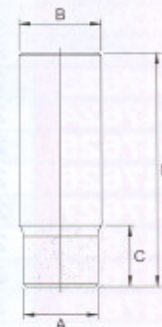
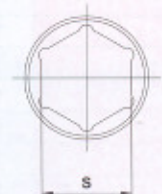

1/2" 手動套筒 1/2" DR. 6PT. SOCKET

- 6PT., metric size
- Material: Chrome vanadium



編號 Item	S	A	B	C	L
43808	8	22.2	12.4	19	38
43809	9	22.2	14.3	19	38
43810	10	22.2	15.4	19	38
43811	11	22.2	16.6	19	38
43812	12	22.2	18	19	38
43813	13	22.2	19.1	19	38
43814	14	22.2	20.2	19	38
43815	15	22.2	21.3	19	38
43816	16	22	23	16.5	38
43817	17	23	23.9	16.5	38
43818	18	23.5	24.9	16.5	38
43819	19	24	26.9	16.5	38
43820	20	24	27.9	16.5	38
43821	21	24	28.9	16.5	38
43822	22	26	29.9	16.5	38
43823	23	28	31	16.5	38
43824	24	28	31.9	16.5	38
43825	25	28	33	16.5	42
43826	26	28	35	16.5	42
43827	27	30	35.9	16.5	42
43829	29	33	39	16.5	42
43830	30	34	39.9	16.5	42
43832	32	36	41.9	16.5	42

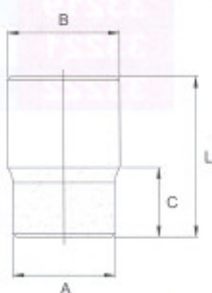
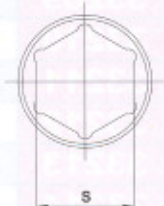

1/2" 長型手動套筒 1/2" DR. 6PT. DEEP SOCKET

- 6PT., Metric size
- Material: Chrome vanadium

編號 Item	S	A	B	C	L
47608	8	22.1	12.7	20	76
47609	9	22.1	14.3	20	76
47610	10	22.1	15.4	20	76
47611	11	22.1	16.6	20	76
47612	12	22.1	18	20	76
47613	13	22.1	19.1	20	76
47614	14	22.1	20.2	20	76
47615	15	22.1	21.3	20	76
47616	16	22	23	20	76
47617	17	23	23.9	20	76
47618	18	23	24.9	20	76
47619	19	24	26.9	20	76
47620	20	24	27.9	20	76
47621	21	24	29	20	76
47622	22	26	29.9	20	76
47623	23	28	31.1	20	76
47624	24	28	31.9	20	76
47625	25	30	33.9	20	76
47626	26	30	35	20	76
47627	27	32	35.9	20	76
47629	29	36	39	20	76
47630	30	36	39.9	20	76
47632	32	38	41.9	20	76

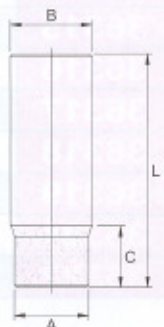

1/2" 手動套筒 1/2" DR. 12PT. SOCKET

- 12PT., metric size
- Material: Chrome vanadium

編號 Item	S	A	B	C	L
43908	8	22.2	12.4	19	38
43909	9	22.2	14.3	19	38
43910	10	22.2	15.4	19	38
43911	11	22.2	16.6	19	38
43912	12	22.2	18	19	38
43913	13	22.2	19.1	19	38
43914	14	22.2	20.2	19	38
43915	15	22.2	21.3	19	38
43916	16	22	23	16.5	38
43917	17	23	23.9	16.5	38
43918	18	23.5	24.9	16.5	38
43919	19	24	26.9	16.5	38
43920	20	24	27.9	16.5	38
43921	21	24	28.9	16.5	38
43922	22	26	29.9	16.5	38
43923	23	28	31	16.5	38
43924	24	28	31.9	16.5	38
43925	25	28	33	16.5	42
43926	26	28	35	16.5	42
43927	27	30	35.9	16.5	42
43929	29	33	39	16.5	42
43930	30	34	39.9	16.5	42
43932	32	36	41.9	16.5	42

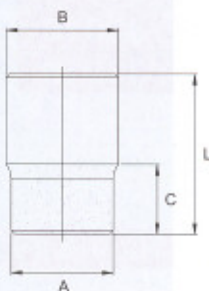
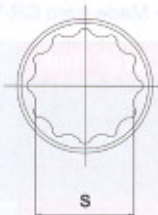

1/2" 長型手動套筒 1/2" DR. 12PT. DEEP SOCKET

- 12PT., Metric size
- Material: Chrome vanadium

編號 Item	S	A	B	C	L
47708	8	22.1	12.7	20	76
47709	9	22.1	14.3	20	76
47710	10	22.1	15.4	20	76
47711	11	22.1	16.6	20	76
47712	12	22.1	18	20	76
47713	13	22.1	19.1	20	76
47714	14	22.1	20.2	20	76
47715	15	22.1	21.3	20	76
47716	16	22	23	20	76
47717	17	23	23.9	20	76
47718	18	23	24.9	20	76
47719	19	24	26.9	20	76
47720	20	24	27.9	20	76
47721	21	24	29	20	76
47722	22	26	29.9	20	76
47723	23	28	31.1	20	76
47724	24	28	31.9	20	76
47725	25	30	33.9	20	76
47726	26	30	35	20	76
47727	27	32	35.9	20	76
47729	29	36	39	20	76
47730	30	36	39.9	20	76
47732	32	38	41.9	20	76
47736	36	40	48	22	76

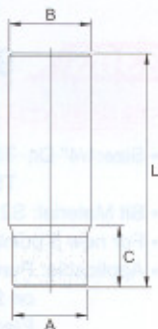
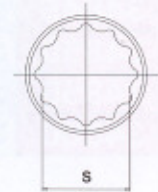



E型外星型套筒 STAR SOCKET

• Made from CR-V steel

編號 Item	S	A	B	C	L
22004	1/4"xE4	11.8	6.2	11	25
22005	1/4"xE5	11.8	7.2	11	25
22006	1/4"xE6	11.8	8.2	11	25
22007	1/4"xE7	11.8	9	11	25
22008	1/4"xE8	11.8	10.3	11	25
33010	3/8"xE10	16.9	13.2	12	28
33012	3/8"xE12	16.9	14.8	12	28
33014	3/8"xE14	17.9	16.8	12	28
33016	3/8"xE16	19.9	18.8	12	28
33018	3/8"xE18	21.9	20.8	12	28

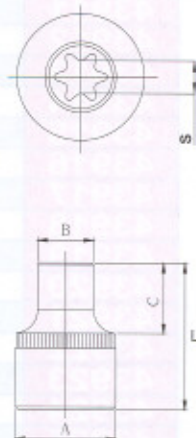

T型(中孔)内星型套筒 TAMPERPROOF STAR BIT SOCKET

- Made from CR-V steel
- Bit Material: S2
- Tamper proof design for special screws.

編號 Item	S	A	B	C	L
23510	1/4"xT10H	11.9	10.8	15	37
23515	1/4"xT15H	11.9	10.8	15	37
23520	1/4"xT20H	11.9	10.8	15	37
23525	1/4"xT25H	11.9	10.8	15	37
23527	1/4"xT27H	11.9	10.8	15	37
23530	1/4"xT30H	11.9	10.8	15	37
34840	3/8"xT40H	17.9	15.8	18	48
34845	3/8"xT45H	17.9	15.8	18	48
34850	3/8"xT50H	17.9	15.8	18	48
34855	3/8"xT55H	19.9	17.8	18	48
34860	3/8"xT60H	19.9	17.8	18	48

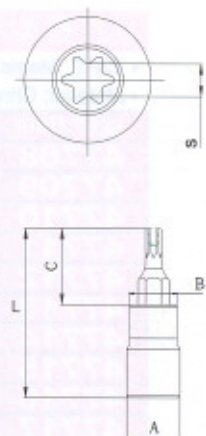

3303 9PC 5PT. STAR SOCKET SET

5角星型(中孔)套筒組9PCS (TAMPER PROOF)

- Size: 1/4" Dr. TS10H, TS15H, TS20H, TS25H, TS27H, TS30H, TS40H, TS45H, TS50H.
- Bit Material: S2
- For new 5 point tamper-proof bolts.
- Applicable: Pumps on PD fuel-injection systems on BENZ HGV(e.g. Atego, Actros) Electronic Stability Ayatem (EWS3) on ROVER 75 and MG ZT.



H211M 1/4" x 11PCS DEEP SOCKET SET

1/4" x 11PCS 長型套筒組 ○

- Contents:
11 pc 1/4" socket: 4, 5, 5.5, 6, 7, 8, 9, 10, 11, 12, 13
Bonus storage rail included.
- Socket length: 50mm
- 6 point type.



H312M 3/8" x 12PCS DEEP SOCKET SET

3/8" x 12pcs 長型套筒組 ○

- Contents: 12pcs- 3/8" socket: 8, 9, 10, 11, 12, 13, 14, 15, 16, 17, 18, 19
- Socket length: 63mm
- 6 point type.

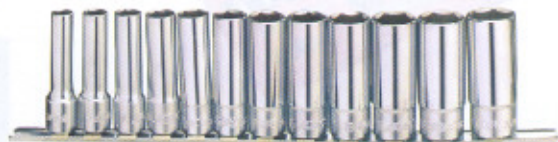

H410M 1/2" x 10PCS DEEP SOCKET SET

1/2" x 10pcs 長型套筒組 ○

- Contents: 10pcs- 1/2" socket: 10, 11, 12, 13, 14, 17, 19, 21, 22, 24
- Socket length: 76mm
- 6 point type.



T410M 1/2" x 10PCS DEEP SOCKET SET(12PT)

1/2" x 10pcs 長型套筒組(12PT) ○

- Contents: 10pcs- 1/2" socket: 10, 11, 12, 13, 14, 17, 19, 21, 22, 24
- Socket length: 76mm
- 12 point type.



3901 10 PC EXTERNAL STAR SOCKET SET

10PC E型套筒組 ○

- Hardened & tempered chrome vanadium steel sockets.
- Professional sand finish.
- Bonus storage rail included.
- Size: 1/4" Dr. - E4, E5, E6, E7, E8
3/8" Dr. - E10, E12, E14, E16, E18



3902 11 PC STAR SOCKET SET

11PC 星型中空套筒組 ☆

- Hardened & tempered chrome vanadium steel sockets.
- Professional sand finish.
- Bonus storage rail included.
- Size: 1/4" Dr. T-10H, T-15H, T-20H, T-25H, T-27H & T-30H.
3/8" Dr. T-40H, T-45H, T-50H, T-55H, T-60H.

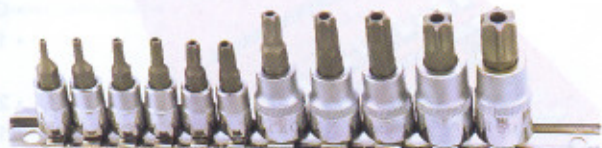



H223S 1/4" x 23 PC SAE SOCKET SET

1/4" x 23PC 英制套筒組 ○

- Contents:
- 13 pc 1/4" socket: 5/32", 3/16", 7/32", 1/4", 9/32", 5/16", 11/32", 3/8", 13/32", 7/16", 15/32", 1/2", 8mm
- 4 pc 1/4" star socket bit: T-20, T-25, T-30, T-40.
- 2 pc 1/4" extension bar: 2", 4".
- 1 pc 1/4" flexible bar.
- 1 pc 1/4" sliding T bar.
- 1 pc 1/4" ratchet handle.
- 1 pc 1/4" universal joint.



H223B 1/4" x 23PC SOCKET SET

1/4" x 23PC 套筒組 ○

- Contents:
- 13 pc 1/4" socket: 4, 4.5, 5, 5.5, 6, 7, 8, 9, 10, 11, 12, 13mm, 1/4".
- 4 pc 1/4" star socket bit: T-20, T-25, T-30, T-40.
- 2 pc 1/4" extension bar: 2", 4".
- 1 pc 1/4" flexible bar.
- 1 pc 1/4" sliding T bar.
- 1 pc 1/4" ratchet handle.
- 1 pc 1/4" universal joint.



H247M 1/4" x 47PC UNIVERSAL SOCKET SET

1/4" x 47 PC 綜合套筒組

- Contents:
- 13PC 1/4" Socket: 4, 4.5, 5, 5.5, 6, 7, 8, 9, 10, 11, 12, 13, 14mm
- 4PC 1/4" long socket: 8, 10, 12, 13mm (50mm)
- ★ 9PC 1/4" star socket bit: T10, T15, T20, T25, T27, T30, T40, T45, T50.
- 3PC 1/4" slotted socket bit: 4, 5.5, 6.5mm.
- ✚ 3PC 1/4" phillips socket bit: PH.1, PH.2, PH.3.
- 6PC 1/4" hex socket bit: 3, 4, 5, 6, 7, 8mm.
- 3PC hex key 1.5, 2, 2.5mm.
- 1 pc 1/4" ratchet handle.
- 2 pc 1/4" extension bar: 2", 4".
- 1 pc 1/4" sliding T bar.
- 1 pc 1/4" universal joint.
- 1 pc 1/4" spinner.



H322B 3/8" x 22PC SOCKET SET

3/8" x 22PC 套筒組 ○

- Contents:
- 16 pc 3/8" socket: 6, 7, 8, 9, 10, 11, 12, 13, 14, 15, 16, 17, 18, 19, 21, 22mm.
- 2 pc 3/8" extension bar: 3", 6".
- 1 pc 3/8" flexible bar.
- 1 pc 3/8" sliding T bar.
- 1 pc 3/8" ratchet handle.
- 1 pc 3/8" universal joint.

H424B 1/2" x 24PC SOCKET SET

1/2" x 24PC 套筒組 ○

- Contents:
- 18 pc 1/2" socket: 10, 11, 12, 13, 14, 15, 16, 17, 18, 19, 21, 22, 23, 24, 27, 29, 30, 32 mm.
- 2 pc 1/2" extension bar: 5", 10".
- 1 pc 1/2" flexible bar.
- 1 pc 1/2" sliding T bar.
- 1 pc 1/2" ratchet handle.
- 1 pc 1/2" universal joint.



T424B 1/2" x 24PC SOCKET SET(12PT)

1/2"x24PC 套筒組(12PT) ○

- Contents:
- 18 pc 1/2" socket: 10, 11, 12, 13, 14, 15, 16, 17, 18, 19, 21, 22, 23, 24, 27, 29, 30, 32mm.
- 2 pc 1/2" extension bar: 5", 10".
- 1 pc 1/2" flexible bar.
- 1 pc 1/2" sliding T bar.
- 1 pc 1/2" ratchet handle.
- 1 pc 1/2" universal joint.



H123C 123PC COMPREHENSIVE TOOL KIT

123PC 綜合型工具組

- Contents:
- 12PC 1/4" Sockets-MM: 4, 4.5, 5, 5.5, 6, 7, 8, 9, 10, 11, 12, 13 MM
- 12PC 1/4" Sockets-IN: 5/32", 3/16", 7/32", 1/4", 9/32", 5/16", 11/32", 3/8", 13/32", 7/16", 15/32", 1/2"
- 7PC 1/4" Deep sockets: 6, 7, 8, 9, 10, 11, 12MM
- 10PC 3/8" Sockets: 8, 9, 10, 11, 12, 13, 14, 15, 16, 17MM
- 4PC 3/8" Deep Sockets: 10, 12, 13, 14MM
- 13PC 1/2" Sockets: 14, 15, 16, 17, 18, 19, 21, 22, 23, 24, 27, 30, 32MM
- 4PC 1/2" Deep Sockets: 14, 17, 19, 21MM
- 5PC 1/4" Star Sockets: E4, E5, E6, E7, E8
- 5PC 3/8" Star Sockets: E10, E12, E14, E16, E18
- ★ 6PC 1/4" Star Sockets Bit: T10H, T15H, T20H, T25H, T27H, T30H
- ★ 5PC 3/8" Star Sockets Bit: T40H, T45H, T50H, T55H, T60H
- ★ 6PC 1/4" Hex Sockets Bit: H3, H4, H5, H6, H7, H8
- +
- 3PC 1/4" Phillips Sockets Bit: PH1, PH2, PH3
- 3PC 1/4" Slotted Sockets Bit: 4, 5.5, 6.5MM
- 2PC 1/4" Extension Bar: 2", 4"
- 2PC 3/8" Extension Bar: 1-3/4", 6"
- 2PC 1/2" Extension Bar: 3", 10"
- 2PC 3/8" Spark Plug Socket: 16, 21MM
- 3PC Ratchet Handle: 1/4", 3/8", 1/2" Dr.
- 3PC Universal Joint: 1/4", 3/8", 1/2" Dr.
- 1PC 1/2" Dr. Flexible Handle.
- 2PC Adaptor: 3/8" (F) x 1/4" (M), 1/2" (F) x 3/8" (M)
- 10PC Comb. Wrenches: 8, 9, 10, 11, 12, 13, 14, 15, 17, 19MM
- 1PC Blow Case.

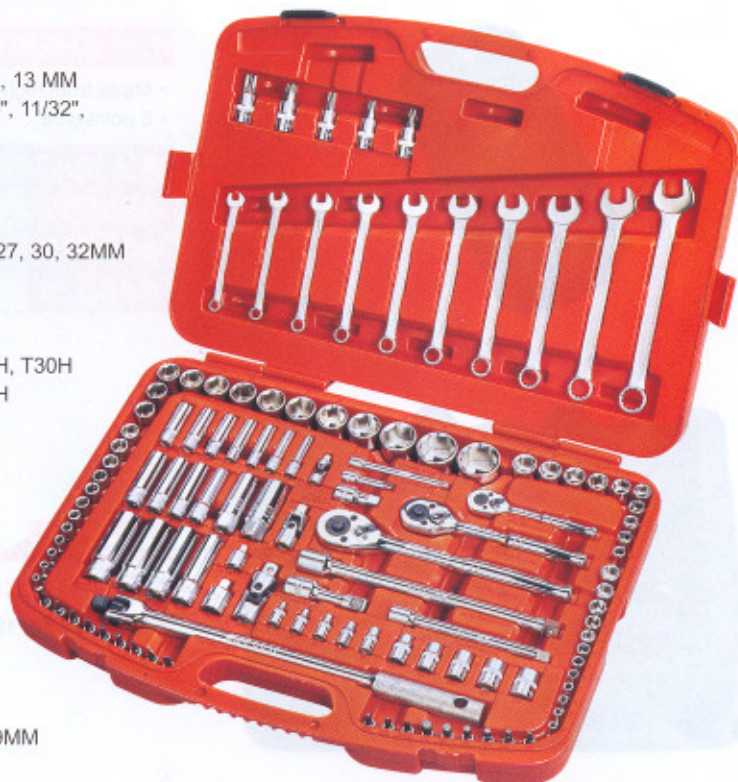

1/2" 氣動套筒 1/2" IMPACT SOCKET

- Made from high quality Chrome Molybdenum steel.
- 6 point type, metric size.

編號 Item	S	A	B	C	L
443808	8	25	14	22	76
443809	9	25	15	22	38
443810	10	25	16.7	22	38
443811	11	25	18	22	38
443812	12	25	19	22	38
443813	13	25	20	22	38
443814	14	25	21.5	22	38
443815	15	25	23	22	38
443816	16	25	24	22	38
443817	17	25	26	17	38
443818	18	25	27	17	38
443819	19	25	28	17	38
443820	20	25	29	17	38
443821	21	25	30	17	38
443822	22	30	32	17	38
443823	23	30	33	17	38
443824	24	30	34	17	38
443825	25	30	35	17	40
443826	26	30	36	17	42
443827	27	30	38	17	42
443829	29	30	41	17	42
443830	30	30	42	17	42
443832	32	30	44	17	42
443833	33	35	46	17	48
443834	34	35	48	17	48
443835	35	35	49	17	48
443836	36	35	50	17	48
443838	38	35	52	17	48
443839	39	35	54	17	48
443841	41	35	56	17	54
443846	46	35	62	17	60

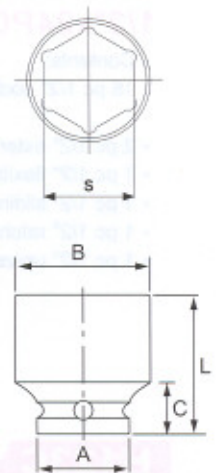

1/2" 中長氣動套筒 1/2" MIDDLE DEEP IMPACT SOCKET

- Made from high quality Chrome Molybdenum steel.
- 6 point type.

編號 Item	規格Spec	外徑Dia.	長度Length
445517	17	25	55
445519	19	27	55
445521	21	30	55

J403A 1/2" 3PCS MIDDLE DEEP IMPACT SOCKET SET

1/2" x 3PCS 中長氣動套筒組

- Contents: 17, 19, 21mm.



1/2"長氣動套筒 1/2" DEEP IMPACT SOCKET

- Made from high quality Chrome Molybdenum steel.
- 6 point type, metric size.

編號 Item	S	A	B	C	L
448208	8	25	14	24	82
448209	9	25	15	24	82
448210	10	25	16.7	24	82
448211	11	25	18	24	82
448212	12	25	19	24	82
448213	13	25	20	24	82
448214	14	25	21.5	24	82
448215	15	25	23	24	82
448216	16	25	24	24	82
448217	17	25	26	17	82
448218	18	25	27	17	82
448219	19	25	28	17	82
448220	20	25	29	17	82
448221	21	25	30	17	82
448222	22	30	32	17	82
448223	23	30	33	17	82
448224	24	30	34	17	82
448225	25	30	35	17	82
448226	26	30	36	17	82
448227	27	30	38	17	82
448229	29	30	41	17	82
448230	30	30	42	17	82
448232	32	30	44	17	82
448233	33	35	46	17	82
448234	34	35	48	17	82
448235	35	35	49	17	82
448236	36	35	50	17	82
448238	38	35	52	17	82
448241	41	35	56	17	82

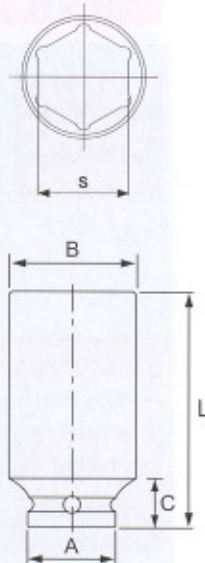

1/2"超薄長氣動套筒 1/2" THIN-WALL DEEP IMPACT SOCKET

- 6 point type.
- Made from special alloy steel with high tenacity and hardness.
- Made from special vacuum heat-treated.

編號 Item	規格Spec	外徑Dia.	長度Length
448117	17	23.4	82
448119	19	25.4	82
448121	21	27.4	82

1/2"超薄中長氣動套筒 1/2" THIN-WALL MIDDLE DEEP IMPACT SOCKET

- 6 point type.
- Made from special alloy steel with high tenacity and hardness.
- Made from special vacuum heat-treated.

編號 Item	規格Spec	外徑Dia.	長度Length
445417	17	23.4	55
445419	19	25.4	55
445421	21	27.4	55

J403B 1/2" 3PCS THIN-WALL MIDDLE DEEP IMPACT SOCKET SET

- Contents: 17, 19, 21mm.





1/4"氣動更換接頭 1/4" IMPACT ADAPTER

• Made from high quality Chrome Molybdenum steel.

編號 Item	規格Spec	外徑Dia.	長度Length
240203	F1/4" X M3/8"	13	26

3/8"氣動更換接頭 3/8" IMPACT ADAPTER

• Made from high quality Chrome Molybdenum steel.

編號 Item	規格Spec	外徑Dia.	長度Length
340302	F3/8" X M1/4"	22	32
340304	F3/8" X M1/2"	22	32

1/2"氣動更換接頭 1/2" IMPACT ADAPTER

• Made from high quality Chrome Molybdenum steel.

編號 Item	規格Spec	外徑Dia.	長度Length
440403	F1/2" X M3/8"	25	38
440406	F1/2" X M3/4"	30	48

3/4"氣動更換接頭 3/4" IMPACT ADAPTER

• Made from high quality Chrome Molybdenum steel.

編號 Item	規格Spec	外徑Dia.	長度Length
640604	F3/4" X M1/2"	44	56
640608	F3/4" X M1"	44	63

1"氣動更換接頭 1" IMPACT ADAPTER

• Made from high quality Chrome Molybdenum steel.

編號 Item	規格Spec	外徑Dia.	長度Length
840806	F1" X M3/4"	54	68

1/2"手動套筒組(展示架型) 1/2" 137PC SOCKET

- 1PC-Metal socket storage
- 137 pcs- 1/2" socket contents

DISPLAY SET

編號 Item	規格 x 數量 Spec. x Quantity		
H4137 (6PT.)	10mm x 10pcs	16mm x 10pcs	24mm x 8pcs
	11mm x 10pcs	17mm x 10pcs	27mm x 7pcs
	12mm x 10pcs	19mm x 10pcs	29mm x 5pcs
T4137 (12PT.)	13mm x 10pcs	21mm x 9pcs	30mm x 5pcs
	14mm x 10pcs	22mm x 8pcs	32mm x 5pcs
	15mm x 10pcs		



1/2"長型手動套筒組(展示架型) 1/2" 137PC DEEP

- 1PC-Metal socket storage
- 137 pcs- 1/2" deep socket contents

DISPLAY SOCKET SET

編號 Item	規格 x 數量 Spec. x Quantity		
H4137L (6PT.)	10mm x 10pcs	16mm x 10pcs	24mm x 8pcs
	11mm x 10pcs	17mm x 10pcs	27mm x 7pcs
	12mm x 10pcs	19mm x 10pcs	29mm x 5pcs
T4137L (12PT.)	13mm x 10pcs	21mm x 9pcs	30mm x 5pcs
	14mm x 10pcs	22mm x 8pcs	32mm x 5pcs
	15mm x 10pcs		

J4137 1/2" 137PC IMPACT SOCKET DISPLAY SET

1/2"氣動套筒組(展示架型)

- Contents:
- 1PC-Metal socket storage
- 137 pcs- 1/2" impact socket

編號 Item	規格 x 數量 Spec. x Quantity		
J4137 (6PT.)	10mm x 10pcs	16mm x 10pcs	24mm x 8pcs
	11mm x 10pcs	17mm x 10pcs	27mm x 7pcs
	12mm x 10pcs	19mm x 10pcs	29mm x 5pcs
	13mm x 10pcs	21mm x 9pcs	30mm x 5pcs
	14mm x 10pcs	22mm x 8pcs	32mm x 5pcs
	15mm x 10pcs		



J4137L 1/2" 137PC DEEP IMPACT SOCKET

1/2"長型氣動套筒組(展示架型)

DISPLAY SET

- Contents:
- 1PC-Metal socket storage
- 137 pcs- 1/2" deep impact socket

編號 Item	規格 x 數量 Spec. x Quantity		
J4137L (6PT.)	10mm x 10pcs	16mm x 10pcs	24mm x 8pcs
	11mm x 10pcs	17mm x 10pcs	27mm x 7pcs
	12mm x 10pcs	19mm x 10pcs	29mm x 5pcs
	13mm x 10pcs	21mm x 9pcs	30mm x 5pcs
	14mm x 10pcs	22mm x 8pcs	32mm x 5pcs
	15mm x 10pcs		

